

HIGH-TEMPERATURE SELF-LUBRICATED FLANGED JOURNAL BEARING

- Flanged journal type
- High temperature — low wear
-65°F to +600°F
(-53.9°C to +315°C)
- Material:
CRES A-286
Liner: Fabroid® X

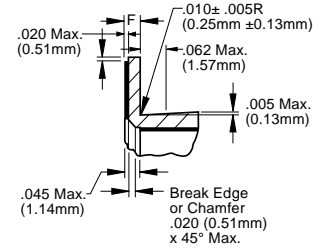
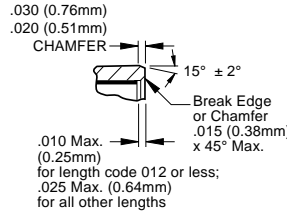
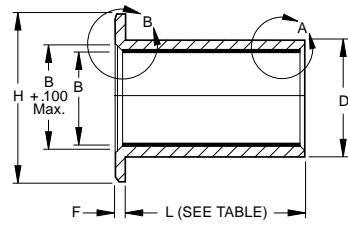

SPECIFICATIONS AND ORDERING INFORMATION

DIMENSIONS – TOLERANCES

Part Number	Nominal Size		B		D		F		H		A286 Journal Weight L = 1.000 in. L = 25.4 mm Ref.		Flange Weight	
	in.	mm	in.	mm	in.	mm	in.	mm	in.	mm	lbs.-in	kg-mm	lbs.-in	kg-mm
07-450-04-0(xx)†	1/4	6.350	.2515	6.388	.3760	9.550	.0625	1.588	.750	19.05	.009	.004	.003	.001
07-450-05-0(xx)†	5/16	7.938	.3140	7.976	.4386	11.140	.0625	1.588	.812	20.62	.011	.005	.003	.001
07-450-06-0(xx)†	3/8	9.525	.3765	9.563	.5012	12.730	.0625	1.588	.875	22.22	.012	.005	.003	.001
07-450-07-0(xx)†	7/16	11.112	.4390	11.151	.5638	14.321	.0625	1.588	.937	23.80	.013	.006	.003	.001
07-450-08-0(xx)†	1/2	12.700	.5015	12.738	.6265	15.913	.0625	1.588	1.000	25.40	.015	.007	.004	.002
07-450-09-0(xx)†	9/16	14.288	.5640	14.326	.6892	17.506	.0625	1.588	1.125	28.58	.017	.008	.004	.002
07-450-10-0(xx)†	5/8	15.875	.6265	15.913	.8142	20.681	.0625	1.588	1.250	31.75	.027	.012	.005	.002
07-450-11-0(xx)†	11/16	17.462	.6890	17.501	.8767	22.268	.0625	1.588	1.375	34.92	.030	.014	.007	.003
07-450-12-0(xx)†	3/4	19.050	.7515	19.088	.9393	23.858	.0625	1.588	1.500	38.10	.034	.015	.009	.004
07-450-14-0(xx)†	7/8	22.225	.8765	22.263	1.0645	27.038	.0625	1.588	1.625	41.28	.038	.017	.009	.004
07-450-16-0(xx)†	1	25.400	1.0015	25.438	1.1898	30.221	.0625	1.588	1.750	44.45	.043	.020	.010	.005
07-450-18-0(xx)†	1 1/8	28.575	1.1265	28.613	1.3148	33.396	.0937	2.380	1.875	47.62	.051	.023	.014	.006
07-450-20-0(xx)†	1 1/4	31.750	1.2515	31.788	1.4398	36.571	.0937	2.380	2.000	50.80	.058	.026	.018	.008
07-450-22-0(xx)†	1 3/8	34.925	1.3765	34.963	1.5648	39.746	.0937	2.380	2.125	53.98	.063	.029	.019	.009
07-450-24-0(xx)†	1 1/2	38.100	1.5015	38.138	1.7523	44.508	.0937	2.380	2.250	57.15	.084	.038	.018	.008
07-450-26-0(xx)†	1 5/8	41.275	1.6265	41.313	1.8773	47.683	.0937	2.380	2.375	60.32	.090	.041	.020	.009
07-450-28-0(xx)†	1 3/4	44.450	1.7515	44.488	2.0023	50.858	.0937	2.380	2.500	63.50	.098	.044	.023	.010
07-450-32-0(xx)†	2	50.800	2.0015	50.838	2.2523	57.208	.0937	2.380	2.750	69.85	.111	.050	.026	.012

Add length designation in 1/32 in. increments. (See below.)

†Add length designations in 2 digits.

LENGTH DESIGNATORS

Part Number	Length: + 000, -.010 in./ +00, -.25mm																													
	1/4	9/32	5/16	11/32	3/8	7/16	1/2	9/16	5/8	11/16	3/4	7/8	1	1 1/8	1 1/4	1 3/8	1 1/2	1 5/8	1 3/4	1 7/8	2	2 1/8	2 1/4	2 3/8	2 1/2	2 3/4	3			
07-450-04-0(xx)	08	09	10	11	12	14																								
07-450-05-0(xx)	08	09	10	11	12	14	16	18																						
07-450-06-0(xx)	08	09	10	11	12	14	16	18	20	22																				
07-450-07-0(xx)	08	09	10	11	12	14	16	18	20	22	24	28																		
07-450-08-0(xx)	08	09	10	11	12	14	16	18	20	22	24	28	32	36																
07-450-09-0(xx)	08	09	10	11	12	14	16	18	20	22	24	28	32	36	40	44														
07-450-10-0(xx)	08	09	10	11	12	14	16	18	20	22	24	28	32	36	40	44	48	52												
07-450-11-0(xx)	08	09	10	11	12	14	16	18	20	22	24	28	32	36	40	44	48	52												
07-450-12-0(xx)	08	09	10	11	12	14	16	18	20	22	24	28	32	38	40	44	48	52												
07-450-14-0(xx)	08	09	10	11	12	14	16	18	20	22	24	28	32	36	40	44	48	52												
07-450-16-0(xx)	08	09	10	11	12	14	16	18	20	22	24	28	32	36	40	44	48	52	56	60										
07-450-18-0(xx)			10	11	12	14	16	18	20	22	24	28	32	36	40	44	48	52	56	60										
07-450-20-0(xx)			12	14	16	18	20	22	24	28	32	36	40	44	48	52	56	60	64	68										
07-450-22-0(xx)			12	14	16	18	20	22	24	28	32	36	40	44	48	52	56	60	64	68										
07-450-24-0(xx)			12	14	16	18	20	22	24	28	32	36	40	44	48	52	56	60	64	68	72	76	80	88						
07-450-26-0(xx)					16	18	20	22	24	28	32	36	40	44	48	52	56	60	64	68	72	76	80	88	96					
07-450-28-0(xx)					16	18	20	22	24	28	32	36	40	44	48	52	56	60	64	68	72	76	80	88	96					
07-450-32-0(xx)					16	18	20	22	24	28	32	36	40	44	48	52	56	60	64	68	72	76	80	88	96					

©2008 RBC Bearings Incorporated. All rights reserved.

JOURNAL BEARINGS